

refrigeration

January 2006 new product introductions
Retail Sales



imagination at work



custom style

New product introductions 2006
GE Profile™ and GE® CustomStyle™ refrigerators



imagination at work



Your dream kitchen starts with a CustomStyle™ refrigerator.



This is the stuff dreams are made of. GE Profile™ and GE® CustomStyle side-by-side refrigerators feature wonderfully innovative design elements that make it possible to have the look of a true built-in refrigerator without the expense.

The magic lies in counter-depth styling, which allows CustomStyle refrigerators to blend in almost seamlessly with surrounding cabinetry. The refrigerator simply slides into the space between cabinets, providing the built-in look consumers dream of—and ask for!

An array of design options truly puts the “style” in CustomStyle refrigerators. Models come with panels or without, with choices of color, and handle style and many outstanding features. Dream on!

Putting the “style” in CustomStyle™ refrigerators

The magic of counter-depth styling

The sleek, expensive-looking, built-in appearance of GE® and GE Profile™ CustomStyle refrigerators is made possible by their ingenious counter-depth design. Simply put, they don't protrude, but instead fit almost completely flush with surrounding cabinetry. With a CustomStyle refrigerator, the whole kitchen looks new.

It's like a dream come true!



CustomStyle—counter-depth



Traditional—with case exposed

The “How-To” for making dreams come true

Three simple steps. That’s all it takes for your customer to choose the perfect CustomStyle refrigerator. **First**, choose either a model designed to accept slide-in panels, or a stylish no-panel model.

Second, choose a model that fits. Panel-ready and no-panel models are both available in 23 and 25 cu. ft. sizes. Width and depth are identical, but the 25 cu. ft. model is almost three inches taller.

Third, choose must-have features, arranged in groups and identified by series letters Q, K, M, N and P.

One, two, three and a dream kitchen is born!





CustomStyle™ side-by-side refrigerators quick pitch

Freshness at every level



Stylish Appearance

Counter-depth styling provides a sleek, stylish built-in look.



Exceptional Food Preservation

ClimateKeeper2™ with two evaporators keeps fresh foods **garden fresh longer** and keeps frozen foods at their best.



Ultimate Convenience

Easy-to-use **PreciseFill technology** provides fresh, filtered water in **accurately** measured amounts.



What's new: Updated features enhance convenience and good looks

Freshness at every level

GE Profile CustomStyle™ side-by-side refrigerators are loaded with innovative features designed to make every kitchen more functional...and more beautiful! PreciseFill technology means it's now possible to fill pots and mixing bowls—or any container—with fresh, filtered water in easy-to-select, accurate measurements. Add an attractive, new dispenser design and there you have it—the “wow” factor today's consumers really want.



PreciseFill technology makes cooking easier

Accurate and easy to use, PreciseFill dispenses the amount of water needed—by ounces or cups—with a simple, two-button programming function.

Newly-designed integrated dispenser adds style

The sleek, molded, color-matched dispenser with LED lighting gives the entire refrigerator an attractive, updated look that enhances any kitchen.



Three distinct GE Profile appearances appeal to every taste



P-Series models feature the new integrated dispenser with beveled, color-matched design and advanced PreciseFill technology.



N-Series models feature the new integrated dispenser with its beveled, color-matched design.



M-Series models feature an elegant black dispenser with stainless trim.



ExpressChill™ goes solo

Formerly available only as a function of CustomCool™ technology, ExpressChill now performs its magic as a solo act! The full-extension, sealed crisper chills beverages quickly. Three chill time settings of 15, 30 or 45 minutes are controlled with easy, one-button selection.

Feature gallery: CustomStyle™ side-by-side refrigerators



SmartWater™ filtration system

Removes more impurities. The result is clean, great-tasting water and ice.



Integrated Ice™ system

The bucket is integrated into the icemaker, freeing up valuable space. Tilt-down feature provides easy access.

only GE has it



QuickSpace™ shelf

Slides out of the way to make room for tall items.



Integrated dispenser with PreciseFill

Allows filling of any container with fresh, filtered water dispensed in easy-to-select, accurate measurements.

new!
only GE has it



Slide 'n Store™ full-extension freezer baskets

Extends 16" for easy loading and unloading.



It chills!



It thaws!



It preserves!

only GE has it

Full-extension bin with CustomCool™ technology

Chills in minutes, thaws in hours and helps keep foods fresh, longer.



GE Profile™ model PSC23PSTSS



Electronic controls with actual temperature display

Takes the guesswork out of selecting temperatures.



TurboCool™ feature

Cools the refrigerator after frequent door openings.



Electronic beverage center

Keep beverages and treats icy cold and easily accessible.



Adjustable ClearLook™ bins

Hold gallon-size containers with style and ease, freeing up valuable shelf space.



Slide-out, spillproof glass shelves

Simplify loading, unloading and cleaning.

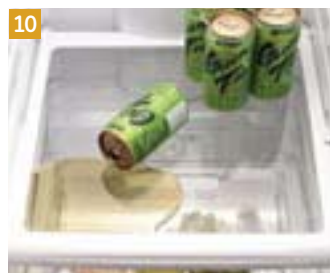

GE Reveal™ lighting

Casts a pure, natural-looking glow throughout the refrigerator.



ge advantage

ClimateKeeper2™ system

Keeps foods garden fresh longer, while protecting ice from odor transfer, with its unique dual-evaporator system.

Available on CustomStyle models:

- | | |
|----------|----------|
| PSC23PST | PSC25NST |
| PSW23PST | PCF25PGT |
| PSH23PGT | PSC25PST |
| PSH23PST | PSH25MGT |
| PSC25MGT | PSH25MST |
| PSC25MST | PSH25PST |
| PCF25NGT | |

only GE has it

new!
only GE has it

The inside story: GE Profile CustomStyle™ side-by-side refrigerators

The ClimateKeeper2™ system uses two evaporators to create two separate climates—one for the fresh food compartment and a separate one for the freezer. Creating and maintaining higher humidity for fresh foods helps keep them garden fresh longer. Providing a dry environment for frozen foods keeps them at their best.

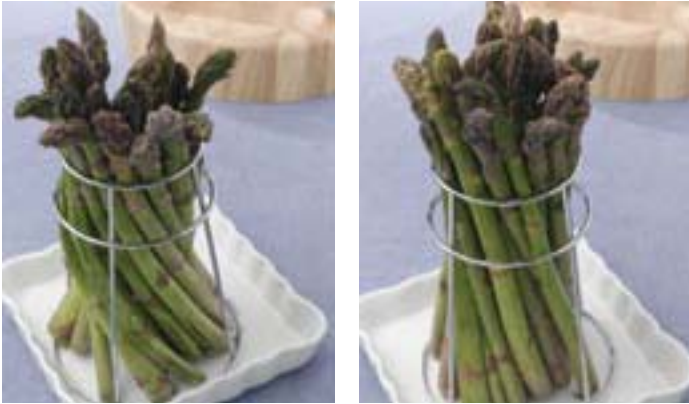

On the left:
**Asparagus after five days—
Conventional system**
Stalks have begun to bend
and appear lifeless.

On the right:
**Asparagus after five days—
ClimateKeeper2 system**
Fresh-looking in texture and
color, the bright-green stalks
stand straight.

ClimateKeeper2 dual-evaporator system

- Keeps food garden fresh longer
- Reduces defrost cycles to help keep frozen foods at their best
- Cycles air in the fresh food compartment separately from freezer air, preventing the transfer of food odors

Conventional single-evaporator system

- Allows air and odors to circulate between the fresh food and freezer compartments
- Dry air from the freezer absorbs moisture from fresh foods
- Allows humidity from the fresh food compartment to transfer to the freezer, causing more frequent defrosting and the increased chance of freezer burn



“Finally, ClimateKeeper2 brings out the best in foods. It keeps temperature and humidity under control so foods stay fresh longer.”

—Alton Brown, Host/Writer of Food Network's "Good Eats"



AutoEnergy saver
Senses freezer and fresh food door openings and adjusts the refrigeration operation cycles accordingly.

ge advantage



FrostGuard™ technology
Protects frozen items from freezer burn by monitoring freezer door openings and defrosting only when needed.

ge advantage



NeverClean™ condenser
Encased coils don't require cleaning in normal operating environments.



Premium quiet design
Significantly reduces operating noise.



ENERGY STAR®-qualified
Most side-by-side models are ENERGY STAR-qualified. See chart on pages 36-37 for details.

CustomStyle™ refrigerators

Available models



GE Profile™ Full-wrap

- Available in 23 cu. ft. capacity
- Color option: Stainless steel



GE Profile Trimless

- Available in 23 and 25 cu. ft. capacities
- Color option: Stainless steel



GE Profile Trimless

- Available in 23 and 25 cu. ft. capacities
- Color options: white, bisque, black, high-gloss or textured



GE Profile Visor handles

- Available in 23 and 25 cu. ft. capacities
- Color option: Stainless steel



**GE Profile
Installed trim**

- Available in 23 and 25 cu. ft. capacities
- Color options: white, bisque or black



**GE®
Trimless**

- Available in 23 cu. ft. capacity
- Color option: Stainless steel



**GE
Trimless**

- Available in 22 and 23 cu. ft. capacities
- Color options: white or black



**GE
Visor handles**

- Available in 22 cu. ft. capacity
- Color option: CleanSteel™

GE Profile CustomStyle™ side-by-side refrigerators—freshness at every level.



Stylish Appearance

Counter-depth styling provides a sleek, stylish **built-in look**.



Exceptional Food Preservation

ClimateKeeper2™ with two evaporators keeps fresh foods **garden fresh longer** and keeps frozen foods at their best



Ultimate Convenience

Easy-to-use **PreciseFill technology** provides fresh, filtered water in **accurately** measured amounts.



side-by-sides

New product introductions 2006
GE Profile™ and GE® side-by-side refrigerators



imagination at work



Side-by-side refrigerators quick pitch

Freshness at every level



Stylish Appearance

Beveled door design and matching color scheme give the integrated dispenser an attractive, updated look.



Exceptional Food Preservation

ClimateKeeper2™ with two evaporators keeps fresh foods **garden fresh longer** and keeps frozen foods at their best.



Ultimate Convenience

Easy-to-use **PreciseFill technology** provides fresh, filtered water in **accurately** measured amounts.



What's new: Updated features enhance convenience and good looks

Freshness at every level

GE Profile™ side-by-side refrigerators are loaded with innovative features designed to make every kitchen more functional...and more beautiful! PreciseFill technology means it's now possible to fill pots and mixing bowls—or any container—with fresh, filtered water in easy-to-select, accurate measurements. Add an attractive, new dispenser design and there you have it—the “wow” factor today's consumers really want.



PreciseFill technology makes cooking easier

Accurate and easy to use, PreciseFill dispenses the amount of water needed—by ounces or cups—with a simple, two-button programming function.

Newly-designed integrated dispenser adds style

The sleek, molded, color-matched dispenser with LED lighting gives the entire refrigerator an attractive, updated look that enhances any kitchen.



Three distinct GE Profile appearances appeal to every taste



P-Series models feature the new integrated dispenser with beveled, color-matched design and advanced PreciseFill technology.



N-Series models feature the new integrated dispenser with its beveled, color-matched design.



M-Series models feature an elegant black dispenser with stainless trim.



ExpressChill™ goes solo

Formerly available only as a function of CustomCool™ technology, ExpressChill now performs its magic as a solo act! The full-extension, sealed crisper chills beverages quickly. Three chill time settings of 15, 30 or 45 minutes are controlled with easy, one-button selection.

What's new: Enhanced features update GE® refrigerators

Freshness at every level



GE models now have a smart, new look—and enhanced functionality—thanks to what's on the outside.

Refined features update the look

GE refrigerators sport a newly-designed GE **CleanTouch handle** that's sleek and smooth, with a sure-grip undersurface.

Gently **contoured doors** further enhance GE models, providing a sophisticated, up-to-date appearance.

ExpressChill™

Located on the dispenser is a one-touch control for ExpressChill, a full-extension, sealed crisper that chills beverages in a quick 45 minutes or less.

External controls provide easy access

GE models are redesigned with external electronic controls that include a display of **actual freezer and refrigerator temperatures**. This gives the interior a cleaner, more streamlined appearance.



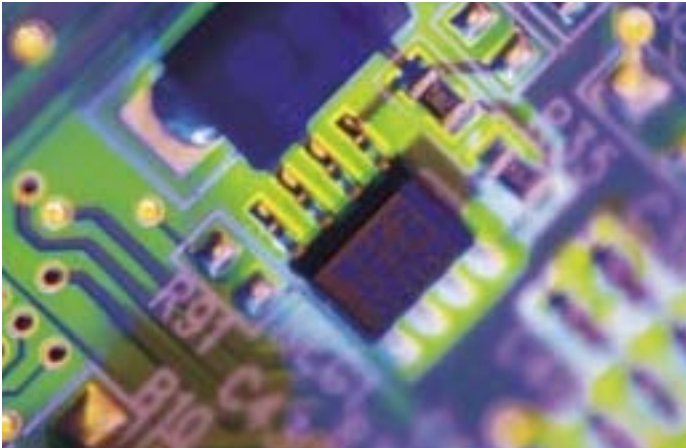

Electronic technology drives performance

Every GE refrigerator is designed using advanced technology that makes possible an impressive array of must-have features:

- AutoEnergy saver senses you're away and adjusts operating cycles to reduce unnecessary usage.
- FrostGuard™ technology reduces freezer burn
- TurboCool™ feature cools the refrigerator after frequent door openings
- Sensor technology monitors temperatures constantly for accuracy and consistency.

GE refrigerators provide must-have features



GE K-Series

K-Series is now expanded with great new features

- ENERGY STAR®-qualified
- CleanTouch handles
- External controls with actual temperature display
- Integrated shelf support system
- Multi-flow air tower
- Dome light
- Low profile hinges
- Dispenser child lock, door alarm and Quick Ice™
- Slide-out, spillproof shelves
- QuickSpace™ shelf
- Integrated Ice™ system
- Freshness Center™



GE Q-Series

Q-Series is now the heart of GE's side-by-side line

- ENERGY STAR-qualified
- CleanTouch handles
- External controls with actual temperature display
- Integrated shelf support system
- Multi-flow air tower
- Dome light
- Low profile hinges
- Dispenser child lock and door alarm
- Slide-out, spillproof shelves
- Adjustable humidity crispers
- SmartWater™ Plus filter (1 yr./500 gal.)
- Available in 23 and 25 cu. ft. capacities



GE J-Series

J-Series is now loaded with extra features

- ENERGY STAR-qualified
- CleanTouch handles
- External temperature controls
- Adjustable humidity crispers
- Snack pan
- Dispenser child lock
- Slide-out, spillproof shelves
- SmartWater filter (6 mos./350 gal.)
- Available in 23 and 25 cu. ft. capacities
- Available in all colors

Feature gallery: GE Profile™ side-by-side refrigerators



1 **SmartWater™ filtration system**
Removes more impurities. The result is clean, great-tasting water and ice.



2 **Integrated Ice™ system**
The bucket is integrated into the icemaker, freeing up valuable space. Tilt-down feature provides easy access.
only GE has it



3 **QuickSpace™ shelf**
Slides out of the way to make room for tall items.



Integrated dispenser with PreciseFill
Allows filling of any container with fresh, filtered water dispensed in easy-to-select, accurate measurements.
new! only GE has it



4 **Slide 'n Store™ full-extension freezer baskets**
Extends 16" for easy loading and unloading.



5
It chills!



It thaws!



It preserves!



GE Profile model PSS26PST

only GE has it

Full-extension bin with CustomCool™ technology

Chills in minutes, thaws in hours and helps keep foods fresh, longer.



Electronic controls with actual temperature display
 Takes the guesswork out of selecting temperatures.



TurboCool™ feature
 Cools the refrigerator after frequent door openings.



Electronic beverage center
 Keep beverages and treats icy cold and easily accessible.



Adjustable ClearLook™ bins
 Hold gallon-size containers with style and ease, freeing up valuable shelf space.



Slide-out, spillproof glass shelves
 Simplify loading, unloading and cleaning.



GE Reveal™ lighting
 Casts a pure, natural-looking glow throughout the refrigerator.



ge advantage

ClimateKeeper2™ system
 Keeps foods garden fresh longer, while protecting ice from odor transfer, with its unique dual-evaporator system.

Available on models:

- | | |
|----------|----------|
| PSF26PGT | PSC25MST |
| PSS26PST | PCF25NGT |
| PSW26PST | PSC25NST |
| PSC23PST | PCF25PGT |
| PSW23PST | PSC25PST |
| PSH23PGT | PSH25MGT |
| PSH23PST | PSH25MST |
| PSC25MGT | PSH25PST |

only GE has it

new!
 only GE has it

The inside story: GE Profile™ side-by-side refrigerators

The ClimateKeeper2™ system uses two evaporators to create two separate climates—one for the fresh food compartment and a separate one for the freezer. Creating and maintaining higher humidity for fresh foods helps keep them garden fresh longer.

Providing a dry environment for frozen foods keeps them at their best.



On the left:

**Asparagus after five days—
Conventional system**

Stalks have begun to bend and appear lifeless.

On the right:

**Asparagus after five days—
ClimateKeeper2 system**

Fresh-looking in texture and color, the bright-green stalks stand straight.

ClimateKeeper2 dual-evaporator system

- Keeps food garden fresh longer
- Reduces defrost cycles to help keep frozen foods at their best
- Cycles air in the fresh food compartment separately from freezer air, preventing the transfer of food odors

Conventional single-evaporator system

- Allows air and odors to circulate between the fresh food and freezer compartments
- Dry air from the freezer absorbs moisture from fresh foods
- Allows humidity from the fresh food compartment to transfer to the freezer, causing more frequent defrosting and the increased chance of freezer burn



“Finally, ClimateKeeper2 brings out the best in foods. It keeps temperature and humidity under control so foods stay fresh longer.”

—Alton Brown, Host/Writer of Food Network's "Good Eats"



ge advantage

AutoEnergy saver
Senses freezer and fresh food door openings and adjusts the refrigeration operation cycles accordingly.



ge advantage

FrostGuard™ technology
Protects frozen items from freezer burn by monitoring freezer door openings and defrosting only when needed.



NeverClean™ condenser
Encased coils don't require cleaning in normal operating environments.



Premium quiet design
Significantly reduces operating noise.



ENERGY STAR®-qualified
Most side-by-side models are ENERGY STAR-qualified. See chart on pages 40-43 for details.

Dare to compare

ClimateKeeper2™ system

- Allows fresh foods to retain the higher moisture levels that keep them at their peak longer
- Fresh foods deteriorate as they lose moisture, becoming dry and unappealing
- Fresh foods last longer at higher relative humidity levels than are produced by single-evaporator systems



Mushrooms after three days with ClimateKeeper2



Mushrooms after three days with conventional system

Compare for yourself—these are not the same!



GE Profile™ P-series includes:

- ClimateKeeper2™
- Electronic beverage center
- PreciseFill technology
- Integrated dispenser
- Sculptured stainless steel handles
- 3 full-extension freezer baskets
- Integrated Ice™
- QuickSpace™ shelf
- TurboCool™
- AutoEnergy saver
- Contoured doors (without a cap)
- FrostGuard™ technology
- GE Reveal™ lighting



Whirlpool® model includes :

New dispenser

- Fast Fill™
- Rotating faucet
- Slide-out dispenser tray



GE offers the most complete stainless exterior line-up!

Choose options such as stainless-wrapped models, stainless trim, integrated stainless, and true stainless sculptured handles.



Competitive comparison—Appearance

	GE Profile™	Kenmore	Whirlpool	KitchenAid
Full-wrapped stainless	Yes	No	No	No
Integrated dispenser	Yes	No	No	No
True stainless handles	Yes	Yes	No	Yes



Exclusive Integrated Ice™ system

- Icemaker and ice bucket are fully integrated into the freezer cabinet to free up valuable storage space and keep ice from clumping
- Ice bucket pulls out and down, providing easy access
- Unique configuration makes room for three full-extension, slide-out freezer baskets for added storage flexibility



Competitive comparison

	GE Profile™	Kenmore Elite	Whirlpool	Frigidaire	Maytag	Amana	KitchenAid	Samsung
Full-extension slide-out freezer baskets	3	1	2	1	None	None	2	None

More space. More convenience. Easy access.

Show and tell

ClimateKeeper2™ system



Bologna after five days with conventional system



Bologna after five days with ClimateKeeper2

Show your customers how the cold, dry freezer air in a conventional system pulls the moisture out of bologna slices. After five days, the bologna slices lose their shape, appear leathery and unappetizing and are ready to be discarded.

Tell your customers how bologna slices remain moist, smooth and uniform in color after five days in the ClimateKeeper2 system.

Use Pub. No. 2-X095 for additional examples of food test.

PreciseFill technology



Show your customers how easy it is to select measured amounts of water by simply pressing a button.

Tell them first to push the button to select whether they want to measure by ounces or cups. Then they press the up or down button on the left side of the display to select whole-ounce or whole-cup amounts. The button on the right is used to select fractions of a cup.

Demo mode



Activate the demo mode function by simultaneously pressing the fresh food WARMER pad and the freezer COLDER pad for three seconds located on the upfront internal controls. To exit demo mode, turn the unit off by unplugging refrigerator. Plug the refrigerator back in after one minute. While in demo mode, demonstrate CustomCool™, PreciseFill and electronic beverage center features.

Exclusive CustomCool™ technology—It chills. It thaws. It preserves!



Show your customers how to select the **ExpressChill™** option of 15, 30 or 45 minutes by pressing the electronic CustomCool pad repeatedly.

Tell your customers how quickly this option allows them to chill beverages for game day or wine for unexpected company.



Show your customers how to select the **ExpressThaw™** options for thawing 1/2 pound, one pound, two pounds and three pounds of meat by pressing the electronic CustomCool pad.

Tell your customers how they can conveniently thaw frozen meats safely even when they're not home. The meat stays refrigerated until they're ready to cook.



Show your customers how to select the **SelectTemp™** options for citrus (43°F), produce (35°F) and meat (31°F) by pressing the electronic CustomCool pad.

Tell your customers how they can protect their favorite foods at the recommended temperature to keep those foods fresh, longer.

Displays



23 cu. ft. or 25 cu. ft. display
Pub. No. 2-D285



42" built-in display
Pub. No. 2-D404



48" built-in display
Pub. No. 2-D295

Side-by-side refrigerators

Available new models



GE® J-Series

- Offered in 22 and 25 cu. ft. capacities
- External electronic temperature controls with child lock
- Adjustable humidity crisper
- Adjustable temperature deli drawer
- Snack pan
- Adjustable gallon door bins
- Adjustable slide-out, spillproof glass shelves
- AutoEnergy saver
- CleanTouch handles
- Available in white, bisque, black, stainless steel and CleanSteel™



GE Q-Series

- Offered in 23 and 25 cu. ft. capacities
- External controls with actual temperature display, child lock and door alarm
- In-the-door can rack
- Integrated shelf support system
- Adjustable humidity crispers
- Air tower
- Low profile hinges
- Dome light
- Available in stainless steel, white, bisque and black



GE K-Series

- Offered in 25 cu. ft. capacity
- Freshness Center™
- Integrated Ice™ system
- In-the-door can rack
- Adjustable humidity snack pan
- Quick Ice™ feature
- ClearLook™ gallon door bins
- QuickSpace™ shelf
- Contoured doors
- Available in white, black and stainless steel



GE L-Series

- Offered in 23 and 25 cu. ft. capacities
- Contoured doors
- ExpressChill™
- Slide-out freezer baskets
- TurboCool™ setting
- Tilt-out freezer door bins
- J beverage rack
- Available in white, black, stainless steel and stainless steel wrapped



GE Profile™ M-Series

- Offered in 23 and 26 cu. ft. capacities
- ClimateKeeper™ system
- ExpressChill with three settings
- Electronic temperature controls with actual temperature display
- Adjustable tilt-out freezer door bins
- Full-extension freezer baskets (2)
- Improved lighting
- In-the-door beverage rack
- Sculptured handles
- Available in white, bisque, black, stainless steel and stainless steel wrapped



GE Profile P-Series

- Offered in 26 cu. ft. capacity
- ClimateKeeper2™ system
- PreciseFill technology
- Integrated dispenser with LED lighting
- Electronic beverage center
- CustomCool™ technology with full-extension drawer
- GE Reveal™ lighting
- Full-extension freezer baskets (3)
- Available in high-gloss, stainless steel and stainless steel wrapped

GE Profile Arctica® and GE CustomStyle™ side-by-side refrigerators

	GE Profile					
	PSC25PST	PCF25PGT	PSH25PST	PSC25NST	PSC25MST PSC25MGT	PSH25MST PSH25MGT
Stainless steel model	●		●	●	●/-	●/-
Capacity						
Total (cu. ft.)	24.6	24.6	24.6	24.6	24.6	24.6
Fresh food (cu. ft.)	15.28	15.28	15.28	15.28	15.28	15.28
Freezer (cu. ft.)	9.32	9.32	9.32	9.32	9.32	9.32
Shelf area (sq. ft.)	20.6	20.6	20.6	21	20.7	20.7
Fresh food features						
Electronic beverage center	●	●	●			
ClimateKeeper™ system	ClimateKeeper2™	ClimateKeeper2	ClimateKeeper2	ClimateKeeper2	ClimateKeeper2	ClimateKeeper2
Dual evaporator	●	●	●	●	●	●
Multi-flow air system	●	●	●	●	●	●
Actual temperature display	●	●	●	●	●	●
Electronic sensors	●	●	●	●	●	●
TurboCool™ setting	●	●	●	●	●	●
SmartWater™ filtration system	Plus	Plus	Plus	Plus	Plus	Plus
LightTouch™ dispenser	Crushed ice, cubes, water	Crushed ice, cubes, water	Crushed ice, cubes, water	Crushed ice, cubes, water	Crushed ice, cubes, water	Crushed ice, cubes, water
Integrated design	●	●		●		
PreciseFill	●	●	●			
Light	LED	LED	LED	LED	●	●
Child lock	●	●	●	●	●	●
Door alarm	●	●	●	●	●	●
Quick Ice™ feature	●	●	●	●	●	●
Water filter indicator light	●	●	●	●	●	●
Cabinet shelves	3 glass	3 glass	3 glass	3 glass	3 glass	3 glass
Adjustable	3	3	3	3	3	3
Slide-out, spillproof	2	2	2	2	2	2
QuickSpace™ shelf	●	●	●	●	●	●
Integrated shelf support system	●	●	●	●	●	●
Snugger™ clip(s)	1	1	1	2	2	2
Freshness Center™	●	●	●	●	●	●
Deli drawer	Adj. temp.	Adj. temp.	Adj. temp.	Adj. temp.	Adj. temp.	Adj. temp.
Vegetable/fruit crisper	Adj. humidity	Adj. humidity	Adj. humidity	Adj. humidity	Adj. humidity	Adj. humidity
Full-extension sealed drawer	CustomCool™	CustomCool	CustomCool	CustomCool	ExpressChill™ with 3 settings	ExpressChill with 3 settings
ClearLook™ door bins	4 (3 adj.)	4 (3 adj.)	4 (3 adj.)	5 (4 adj.)	5 (4 adj.)	5 (4 adj.)
Dairy compartment (removable)	●	●	●	●	●	●
GE Profile beverage rack	Electronic beverage center	Electronic beverage center	Electronic beverage center	In-the-door	In-the-door	In-the-door
Interior light system	GE Reveal™	GE Reveal	GE Reveal	Tri-level	Tri-level	Tri-level
Quiet design	Premium	Premium	Premium	Premium	Premium	Premium
AutoEnergy saver	●	●	●	●	●	●
NeverClean™ condenser	●	●	●	●	●	●
ENERGY STAR®	●	●	●	●	●	●
Freezer features						
FrostGuard™ technology	●	●	●	●	●	●
Integrated Ice™	●	●	●	●	●	●
Wire slide-out baskets	4 (3 full-ext.)	4 (3 full-ext.)	4 (3 full-ext.)	4 (3 full-ext.)	3 (2 full-ext.)	3 (2 full-ext.)
Wire cabinet shelves	2 (1 slide-out)	2 (1 slide-out)	2 (1 slide-out)	2 (1 slide-out)	2 (1 slide-out)	2 (1 slide-out)
Wire tilt-out door bin(s)	3 (2 adj.)	3 (2 adj.)	3 (2 adj.)	3 (2 adj.)	3 (2 adj.)	4 (3 adj.)
Door shelves	1	1	1	1	1	1
Interior light	GE Reveal	GE Reveal	GE Reveal	Dual	Dual	Dual
Exterior						
Color(s) available*	SS	WW, BB	SV	SS	SS WW, BB	SV BV Trimless Installed trim
CustomStyle™ configuration	Trimless	Trimless	Trimless	Trimless	Trimless	Trimless Installed trim
Door handles*	Sculptured stainless steel	CM sculptured	Full-length visor	Sculptured stainless steel	Sculptured stainless steel CM sculptured	Full-length visor CM full-length visor
Exterior design	Rounded doors	High-gloss rounded doors	Squared doors	Rounded doors	Rounded doors Case only (black)	Squared doors Case only (black)
Textured steel door and case	Case only (black)	Case only	Case only (black)	Case only (black)	●	●
Adjustable rollers	Front	Front	Front	Front	Front	Front
Weights & Dimensions						
Height to top of hinge (in.) A	72	72	72-1/8	72	72	72
Height to top of case (in.) B	71-1/2	71-1/2	71-1/2	71-1/2	71-1/2	71-1/2
Case depth without door (in.) C	23-7/8	23-7/8	23-7/8	23-7/8	23-7/8	23-7/8
Case depth less door handle (in.) D	27-1/8	27-1/8	27-1/8	27-1/8	27-1/8	27-1/8
Case depth with door handle (in.) E	29-9/16	29-9/16	28-11/16	29-9/16	29-9/16	29-9/16
Depth w/fresh food door open 90° (in.) F	46	46	46	46	46	46
Width (in.) G	35-3/4	35-3/4	35-3/4	35-3/4	35-3/4	35-3/4
Width w/door open 90° w/door handle (in.) H	38-3/16	38-3/16	37-5/16	38-3/16	38-3/16	38-5/16
Each side (in.)	1/8	1/8	1/8	1/8	1/8	1/8
Top (in.)	1	1	1	1	1	1
Air clearances						
Back (in.)	1/2	1/2	1/2	1/2	1/2	1/2
Approx. shipping wt. (lbs.)	394	394	394	394	394	394
Power/Rating	← 120V, 60Hz, 15Amps →					
Accessories						
Factory trim kit attached	N/A	N/A	N/A	N/A	N/A	N/A / ●
Black collar trim (optional)	N/A	N/A	N/A	N/A	N/A	N/A / TRM25BISBB
White collar trim (optional)	N/A	N/A	N/A	N/A	N/A	N/A
Bisque collar trim (optional)	N/A	N/A	N/A	N/A	N/A	N/A
Stainless steel collar trim (optional)	N/A	N/A	TRM25BISSS	N/A	N/A	TRM25BISSS / N/A

Side-by-side refrigerators

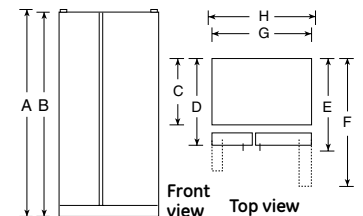

Listed by
Underwriters
Laboratories

*Color(s) available: SV = Stainless steel with visor handles, SS = Stainless steel, WW = White, BV = Black with visor handles, BB = Black, CM = Color-Matched.

If installed against a wall, allow clearance of 13-15/16" on freezer side to remove bin. Clearance required to remove fresh food full size pan without disassembling is 18-5/8".

ALL MODELS AVAILABLE IN U.S. AND CANADA.

	GE Profile							GE®	
	PSW23PST PSC23PST	PSH23PST PSH23PGT	PSC23SHT PSC23NST	PCF23NGT	PSI23NST PSI23NGT	PSI23SCR PSI23NCR	PSC23MGT PSI23MGT	GSC23KST GSC23KGT	GCL22QGT GSC22QGT
Stainless steel model	●	●/-	●		●/-	●/-		●/-	
Capacity									
Total (cu. ft.)	22.6	22.6	22.6	22.6	22.6	22.6	22.6	22.6	22.1
Fresh food (cu. ft.)	14.23	14.23	14.38	14.38	14.38	14.38	14.38	14.38	14.25
Freezer (cu. ft.)	8.38	8.38	8.17	8.17	8.17	8.17	8.25	8.23	7.83
Shelf area (sq. ft.)	19.6	19.6	19.1 / 19.6	19.6	19.6	20.5	18.9	18.5	18.7
Fresh food features									
Refreshment center			●/-						
Electronic beverage center	●	●							
ClimateKeeper system	ClimateKeeper2	ClimateKeeper2	●	●	●	●	●		
Dual evaporator	●	●							
Multi-flow air system	●	●	●	●	●	●	●		
Actual temperature display	●	●	●	●	●	●	●		
External controls								Actual temp display	Actual temp display
Electronic sensors	●	●	●	●	●	●	●	●	●
TurboCool setting	●	●	●	●	●	●	●		
SmartWater filtration system	Plus	Plus	Plus	Plus	Plus		Plus	Plus	Plus
LightTouch! dispenser	Crushed ice, cubes, water	Crushed ice, cubes, water	Crushed ice, cubes, water	Crushed ice, cubes, water	Crushed ice, cubes, water		Crushed ice, cubes, water	Crushed ice, cubes, water	Crushed ice, cubes, water
Integrated design	●	●	- / ●	●					
PreciseFill	●	●							
Light	LED	LED	LED	LED	LED		●	●	●
Child lock and door alarm	●	●	●	●	●		●	●	●
Quick ice feature	●	●	●	●	●		●	●	●
Water filter indicator light	●	●	●	●	●		●	●	●
Cabinet shelves	3 glass	3 glass	3 glass	3 glass	3 glass	3 glass	3 glass	3 glass	3 glass
Adjustable	3	3	3	3	3	3	3	3	3
Slide-out, spillproof	2	2	2	2	2	2	2	2	2
QuickSpace shelf	●	●	●	●	●	●	●	●	●
Integrated shelf support system	●	●	●	●	●	●	●	●	●
Snugger clip(s)	1	1	1 / 2	2	2	2	2		
Freshness Center	●	●	●	●	●	●	●	●	●
Dehi drawer	Adj. temp.	Adj. temp.	Adj. temp.	Adj. temp.	Adj. temp.	Adj. temp.	Adj. temp.	Sealed	Sealed
Vegetable/fruit crisper	Adj. humidity	Adj. humidity	Adj. humidity	Adj. humidity	Adj. humidity	Adj. humidity	Adj. humidity	Adj. humidity	Adj. humidity
Sealed drawer	CustomCool w/full-extension	CustomCool w/full-extension	CustomCool w/full-extension	CustomCool w/full-extension	CustomCool w/full-extension	CustomCool w/full-extension	ExpressChill with 3 settings	●	●
ClearLook door bins	3 (2 adj.)	3 (2 adj.)	3 (1 adj.) / 4 (3 adj.)	4 (3 adj.)	4 (3 adj.)	4 (3 adj.)	4 (3 adj.)	4 (3 adj.)	4 (3 adj.)
Dairy compartment (removable)	●	●	●	●	●	●	●	●	●
Beverage rack	Electronic beverage center	Electronic beverage center	In-the-door	In-the-door	In-the-door	In-the-door	In-the-door	Can storage rack	Can storage rack
Interior light system	GE Reveal	GE Reveal	Tri-level	Tri-level	Tri-level	Tri-level	Dual-level	Dual-level	Dual
Quiet design	Premium	Premium	Premium	Premium	Premium	Premium	Premium	Deluxe	Deluxe
AutoEnergy saver	●	●	●	●	●	●	●	●	●
NeverClean condenser	●	●	●	●	●	●	●	●	●
ENERGY STAR	●	●	●	●	●	●	●	●	●
Freezer features									
FrostGuard technology	●	●	●	●	●	●	●	●	●
Factory-installed icemaker	Integrated Ice	Integrated Ice	Integrated Ice	Integrated Ice	Integrated Ice	●	Integrated Ice	Integrated Ice	●
Wire slide-out baskets	4 (3 full-ext.)	4 (3 full-ext.)	4 (3 full-ext.)	4 (3 full-ext.)	4 (3 full-ext.)	4 (3 full-ext.)	3 (2 full-ext.)	3	1
Wire cabinet shelves	2/2 (1 slide-out)	2	2 (1 slide-out)	2 (1 slide-out)	2 (1 slide-out)	2 (1 slide-out)	2 (1 slide-out)	2 (1 slide-out)	2 (1 slide-out)
Wire tilt-out door bin(s)	3 (2 adj.)	3 (2 adj.)	3 (2 adj.)	3 (2 adj.)	3 (2 adj.)	4 (3 adj.)	3 (2 adj.)		
Door shelves								4 (2 adj.)	3 (2 adj.)
Interior light	Dual	Dual	Dual	Dual	Dual	Dual	Dual	Dual	Single
Exterior									
Color(s) available*	SS	SV WV, BV	SS	WW, CC, BB	SV WV, CV, BV	SV WV, BV	WW, CC, BB WV, BV	SS WW, BB	CleanSteel™ WW, BB
CustomStyle configuration	Trimless	Trimless Installed trim	Trimless	Trimless	Trimless Installed trim	Trimless Installed trim	Trimless Installed trim	Trimless	●
Door handles*	Sculptured stainless steel	Full-length visor CM full-length visor	Sculptured stainless steel	CM sculptured	Full-length visor CM full-length visor	Full-length visor CM full-length visor	CM sculptured CM full-length visor	Tubular stain steel CM CleanTouch	Full-length visor CM CleanTouch
Exterior design	Full-wrap contour Rounded doors	Squared doors Case only (black)	Rounded doors	High-gloss rounded doors	Squared doors Case only (black)	Squared doors Case only (black)	Rounded doors Squared doors	Rounded doors Case only (black)	Rounded doors
Textured steel door and case	Case only (black)	●	Case only (black)	Case only	Case only	Case only	Case only	●	●
Adjustable rollers	All	All	All	All	All	All	All	Front	Front
Weights & Dimensions									
Height to top of hinge (in.) A	70-3/4 / 69-1/4	69-1/4	69-1/4	69-1/4	69-1/4	69-1/4	69-1/4	69-1/4	69-1/4
Height to top of case (in.) B	68-3/4	68-3/4	68-3/4	68-3/4	68-3/4	68-3/4	68-3/4	68-3/4	68-3/4
Height to top of door trim (in.)	70-1/4	70-1/4	70-1/4	70-1/4	70-1/4	70-1/4	- / 70-1/4		
Case depth without door (in.) C	24-3/8 / 23-7/8	23-7/8	23-7/8	23-7/8	23-7/8	23-7/8	23-7/8	23-7/8	23-7/8
Case depth less door handle (in.) D	27-1/4 / 26-3/4	26-3/4	26-3/4	26-3/4	26-3/4	26-3/4	26-3/4	26-3/4	26-3/4
Case depth with door handle (in.) E	29-11/16 / 29-3/16	29-3/16	29-3/16	29-3/16	29-3/16	28-5/16	29-3/16	29-3/16	29-3/16
Depth w/fresh food door open 90° (in.) F	46 / 45-9/16	45-9/16	45-9/16	45-9/16	45-9/16	45-9/16	45-9/16	45-9/16	45-9/16
Width (in.) G	36†† / 35-3/4	35-3/4	35-3/4	35-3/4	35-3/4	35-3/4	35-3/4	35-3/4	35-3/4
Width w/door open 90° w/door handle (in.) H	41-5/16	41	41-5/16	41	40	40	41 / 40	40-3/4	40-3/4
Each side (in.)	1/8	1/8	1/8	1/8	1/8	1/8	1/8	1/8	1/8
Top (in.)	1	1	1	1	1	1	1	1	1
Air clearances Back (in.)	1/2	1/2	1/2	1/2	1/2	1/2	1/2	1/2	1/2
Approx. shipping wt. (lbs.)	390 / 340	350	340	340	350	350	340 / 350	340	340
Power/Rating	120V, 60Hz, 15Amps								
Accessories									
Factory trim kit attached	N/A	N/A / ●	N/A	N/A	●	N/A / ●	N/A / ●	N/A	N/A
Black acrylic panels (optional)	N/A	N/A / PSPK23DBB	N/A	N/A	N/A / PSPK23DBB	N/A	N/A / PSPK23DBB	N/A	N/A
White acrylic panels (optional)	N/A	N/A / PSPK23DWW	N/A	N/A	N/A / PSPK23DWW	N/A	N/A / PSPK23DWW	N/A	N/A
Bisque acrylic panels (optional)	N/A	N/A	N/A	N/A	N/A / PSPK23DCC	N/A	N/A	N/A	N/A
Stainless steel panels (optional)	N/A	N/A / PSPK23DSS	N/A	N/A	N/A / PSPK23DSS	N/A	N/A / PSPK23DSS	N/A	N/A
Black collar trim (optional)	N/A	N/A / TRMBISBB	N/A	N/A	N/A / TRMBISBB	N/A / TRMBISBB	N/A / TRMBISBB	N/A	N/A
White collar trim (optional)	N/A	N/A / TRMBISWW	N/A	N/A	N/A / TRMBISWW	N/A / TRMBISWW	N/A / TRMBISWW	N/A	N/A
Bisque collar trim (optional)	N/A	N/A	N/A	N/A	N/A / TRMBISCC	N/A	N/A	N/A	N/A
Stainless steel collar trim (optional)	N/A	TRMBISSS / N/A	N/A	N/A	N/A	TRMBISSS / N/A	N/A	N/A	N/A

*Color(s) available: SV = Stainless steel with visor handles, SS = Stainless steel, WV = White with visor handles, WW = White, CV = Bisque with visor handles, CC = Bisque, BV = Black with visor handles, BB = Black, CleanSteel = Stainless appearance, CM = Color-Matched.
†When cap is removed: 69-1/4". ††Width excluding caps: 35-7/8".

If installed against a wall, allow clearance of 13-15/16" on freezer side to remove bin. Clearance required to remove fresh food full size pan without disassembling is 18-5/8".
ALL MODELS AVAILABLE IN U.S. AND CANADA.

GE Profile Arctica® and GE CustomStyle™ side-by-side installation information & specifications

Rough-in dimensions

Standard, new construction and replacement installation

Installation tips to maximize the built-in look

- All wall/floor molding should be removed prior to installation.
- Water recess on rear wall recommended to prevent water line damage. 48" minimum length, 1/4"-diameter water line tubing recommended.
- When possible, recess both copper water line and electrical outlet (see local codes).
- Front and rear leveling legs are adjustable for the built-in look (see owner's manual).
- If optional collar trim kit is to be used or anticipated, see collar trim installation on next page for different rough-in dimensions.

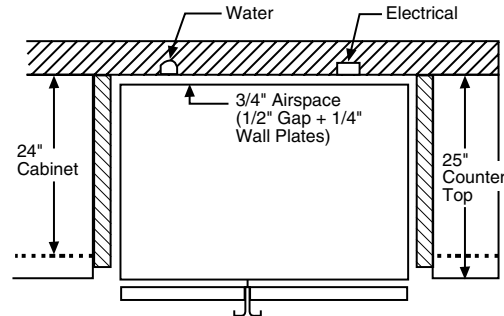
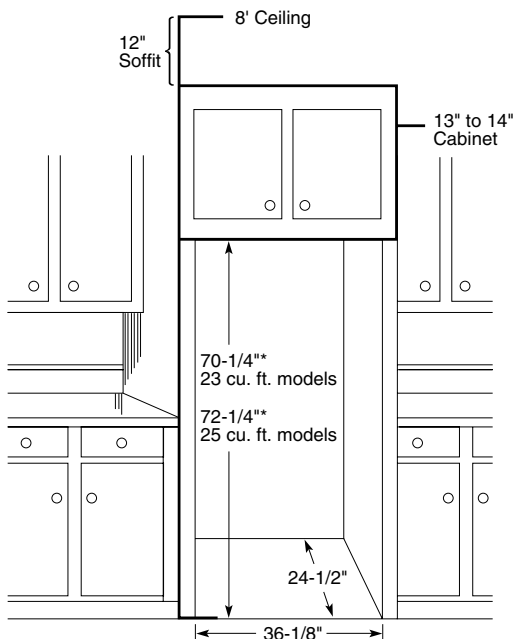

*The rough-in dimensions of 70-1/4"/72-1/4" are minimum and measured from the finished floor to top of opening (or the underside of the overhead cabinets). For Models with Trim Kit: If frameless style cabinets are planned for above the refrigerator, you may need to consider adding a maximum of 1/4" (70-1/2") to height of opening for 23 cu. ft. models and 1/8" (72-3/8") for 25 cu. ft. models to allow additional clearance between cabinet doors and top of refrigerator trim when cabinet doors are in open position.

Installation of water outlets

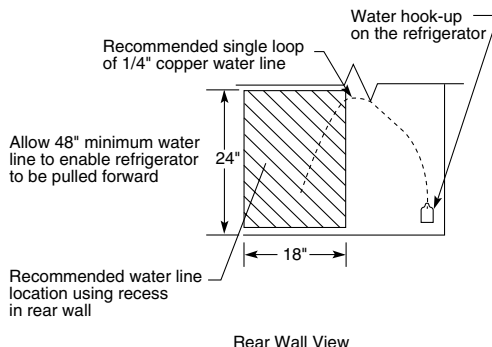
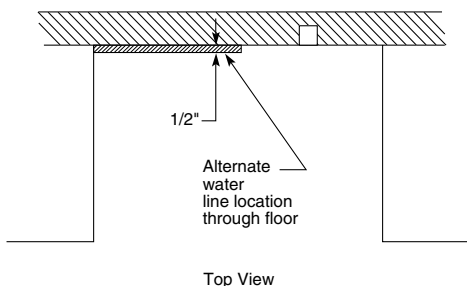

IMPORTANT: Before finalizing specifications for your GE Profile CustomStyle Refrigerator, please NOTE:

- A minimum width of 36" is required for refrigerator installation
- Be sure to allow for 1/2" or 3/4" side panels in addition to the 36" minimum

Create a custom look for your GE Profile CustomStyle side-by-side refrigerator

Still another advantage offered by GE Profile CustomStyle Refrigerators is ease of installation. For a refrigerator that does so much to enhance the beauty of your kitchen, the "behind-the-scenes" preparation and installation are surprisingly simple.

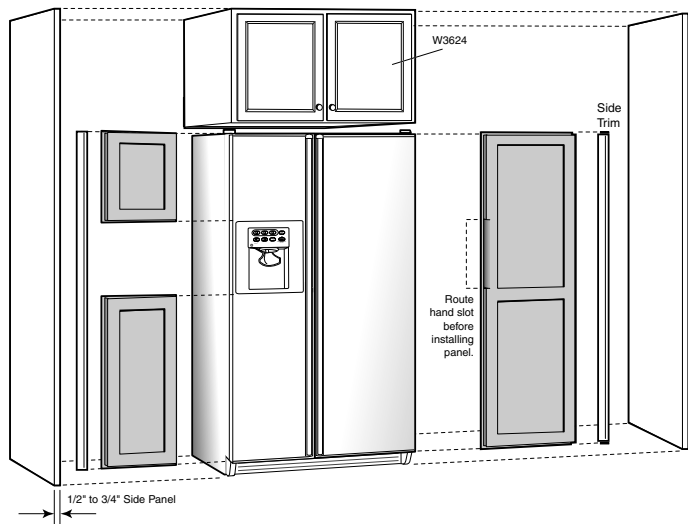

Fabricating the enclosure

- The drawing shows an 84" cabinet elevation. Adjust dimensions accordingly for other cabinet elevations.
- Cabinet pieces to order: (2) side panels and (1) wall cabinet.
- Side panels will typically be attached to adjacent cabinets and/or cleated to rear wall and floor.
- Refer to GE refrigerator installation instructions for proper plumbing, and electrical and air clearances.
- (1) Some framed cabinet lines will make a refrigerator enclosure with a cabinet 12" high x 39" wide with sides and 1-1/2" face frame extended down to floor to create the refrigerator space. This will replace the above construction. (2) A tall cabinet on either side of the refrigerator can replace a side panel.
- Counter overhangs on either side of the refrigerator should have clipped corners to allow for full door swing.
- If the refrigerator has a wall returning beyond the front of the refrigerator on either side, a 2" tall filler will help allow for movement of the door.

Door Panels

- See drawings for exact dimensions of the fresh-food and freezer door panels.
- Refrigerator door fronts from stock and most semi-custom cabinet manufacturers will be supplied as 1/4"-thick panels cut to dimensions, with closest available standard door sizes applied to front.
 - This will leave a "reveal" at top/bottom and sides. Width of "reveal" will depend on manufacturer's standard door sizes.
 - Door will be affixed on the 1/4" panels at factory or in the field by the local supplier, depending on manufacturer.
- Local shop-built or custom cabinet supplier may fabricate custom 3/4" panels. In this case, edges must be routed.
- Follow notes on drawing to assure room for fingers/hands to open handles.

Door panel dimensions (in inches)

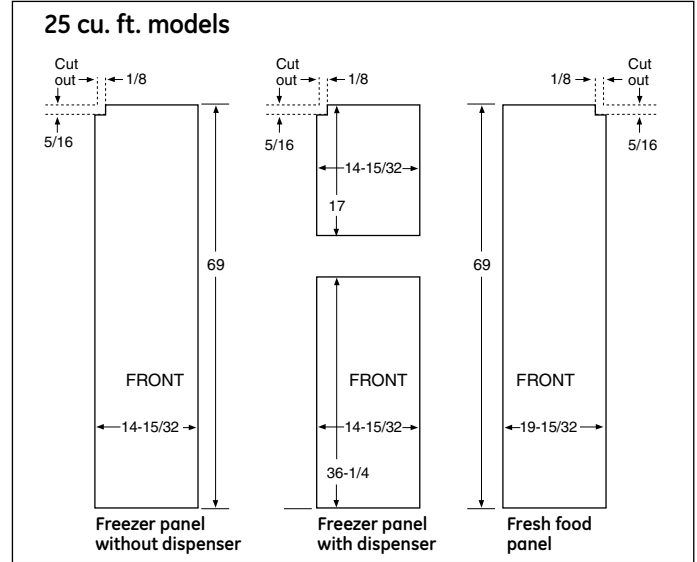
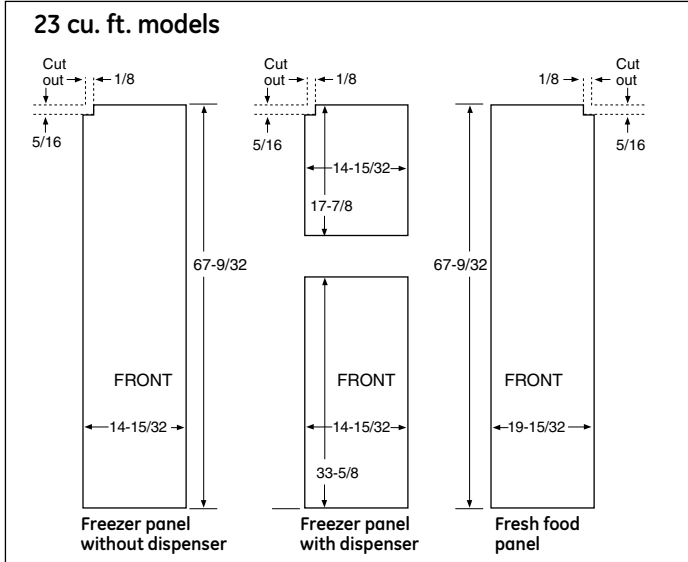

Order your own custom wood panels to match cabinetry or other decor.
 Panels up to 1/4" thick will fit door frame with no special preparation. Add filler behind material thinner than 1/4" for proper fit.
Weight Limits: Total weight of panels (i.e., both freezer panels)—Fresh Food = 38 lbs., Freezer = 28 lbs.
Note: Panels up to 3/4" will require special routing area around handles. Dimensions may vary depending on depth of panel.

Detail C

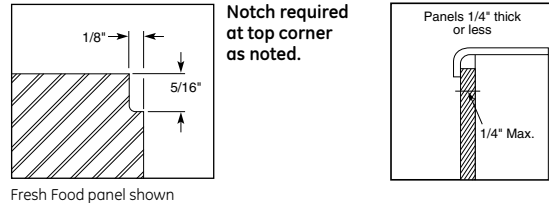

Collar trim installation

An enclosure is **required** to match up to the trim (see Typical Installation). To obtain the most integrated look, the cabinet or soffit above the refrigerator should extend out to the same depth as the side panels. The refrigerator opening must have minimum dimensions of 70-1/4" high x 36-1/8" wide x 24-1/2" deep for **23 cu. ft. models** and 72-1/4" high x 36-1/8" wide x 24-1/2" deep for **25 cu. ft. models**, as shown at right. If there is an overhead cabinet, allow 1" for cabinet door clearance with the top trim piece so the cabinet doors can be opened without hitting the top trim. If 1/2" side panels are used, then side trim and panel will be even. If 3/4" side panels are used, then some of the side panel will extend beyond the trim and must be finished.

IMPORTANT: Before finalizing specifications for your GE Profile CustomStyle Refrigerator, please NOTE:

- A minimum width of 36-1/8" is required for refrigerator installation with collar

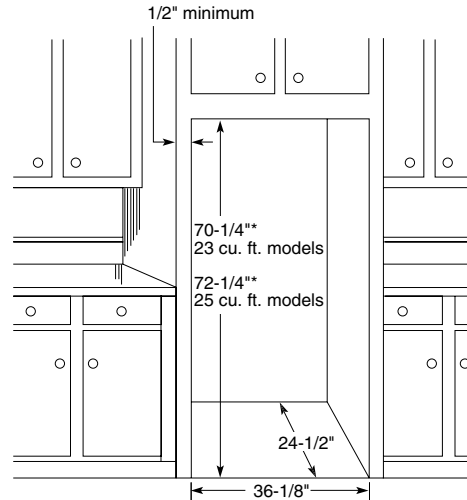

*The rough-in dimensions of 70-1/4"/72-1/4" are minimum and measured from the finished floor to top of opening (or the underside of the overhead cabinets). For Models with Trim Kit: If frameless style cabinets are planned for above the refrigerator, you may need to consider adding a maximum of 1/4" (70-1/2") to height of opening for 23 cu. ft. models and 1/8" (72-3/8") for 25 cu. ft. models to allow additional clearance between cabinet doors and top of refrigerator trim when cabinet doors are in open position.

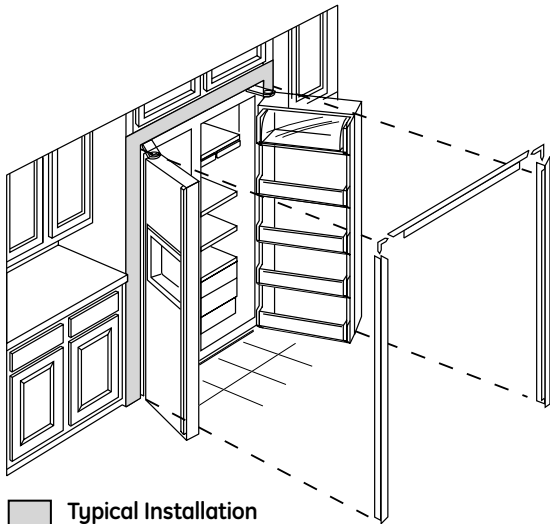

Typical Installation

Shaded areas represent front surfaces of side panels and overhead cabinet or soffit that contacts trim.

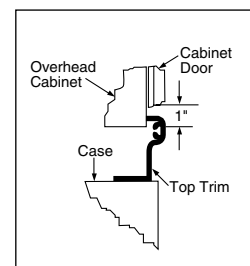
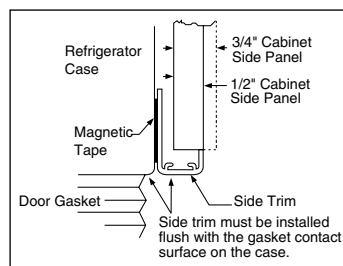

GE Profile Arctica® side-by-side refrigerators

	GE Profile								
	PSW26PST	PSS26PST	PSF26PGT	PSS29NST	PSS27NST	PSS26SHT	PSS26NST	PSF26NGT	
Stainless steel model	●	●	●	●	●	●	●	●	
Capacity									
Total (cu. ft.)	25.5	25.5	25.5	28.5	26.5	25.6	25.5 / 23.1	25.5 / 23.1	
Fresh food (cu. ft.)	15.81	15.81	15.81	17.85	16.60	16.18	16.02 / 15.86	16.02 / 15.86	
Freezer (cu. ft.)	9.69	9.69	9.69	10.68	9.92	9.48	9.48 / 7.26	9.48 / 7.26	
Shelf area (sq. ft.)	20.7	20.7	20.7	24.9	23.7	21.9	22.8 / 19.2	22.8 / 19.2	
Fresh food features									
Refreshment center						●			
Electronic beverage center	●	●	●						
ClimateKeeper™ system	ClimateKeeper2™	ClimateKeeper2	ClimateKeeper2	●	●	●	●	●	
Dual evaporator	●	●	●						
Multi-flow air system	●	●	●	●	●	●	●	●	
Actual temperature display	●	●	●	●	●	●	●	●	
Electronic sensors	●	●	●	●	●	●	●	●	
TurboCool™ setting	●	●	●	●	●	●	●	●	
SmartWater™ filtration system	Plus	Plus	Plus	Plus	Plus	Plus	Plus	Plus	
LightTouch! dispenser	Crushed ice, cubes, water	Crushed ice, cubes, water	Crushed ice, cubes, water	Crushed ice, cubes, water	Crushed ice, cubes, water	Crushed ice, cubes, water	Crushed ice, cubes, water	Crushed ice, cubes, water	
Integrated design	●	●	●	●	●	●	●	●	
PreciseFill	●	●	●						
Light	LED	LED	LED	LED	LED	LED	LED	LED	
Child lock	●	●	●	●	●	●	●	●	
Door alarm	●	●	●	●	●	●	●	●	
Quick Ice™ feature	●	●	●	●	●	●	●	●	
Water filter indicator light	●	●	●	●	●	●	●	●	
Cabinet shelves	3 glass	3 glass	3 glass	3 glass	3 glass	3 glass	3 glass	3 glass	
Adjustable	3	3	3	3	3	3	3	3	
Slide-out, spillproof	2	2	2	2	2	2	2	2	
QuickSpace™ shelf	●	●	●	●	●	●	●	●	
Integrated shelf support system	●	●	●	●	●	●	●	●	
Snuggler™ clip(s)	2	2	2	2	2	2	2	2	
Freshness Center™	●	●	●	●	●	●	●	●	
Delic drawer	Adj. temp.	Adj. temp.	Adj. temp.	Adj. temp.	Adj. temp.	Adj. temp.	Adj. temp.	Adj. temp.	
Vegetable/fruit crisper	Adj. humidity	Adj. humidity	Adj. humidity	Adj. humidity	Adj. humidity	Adj. humidity	Adj. humidity	Adj. humidity	
Full-extension sealed drawer	CustomCool	CustomCool	CustomCool	CustomCool™	CustomCool	CustomCool	CustomCool	CustomCool	
ClearLook™ door bins	3 (2 adj.)	3 (2 adj.)	3 (2 adj.)	4 (3 adj.)	4 (3 adj.)	3 (1 adj.)	4 (3 adj.)	4 (3 adj.)	
Dairy compartment (removable)	●	●	●	●	●	●	●	●	
Beverage rack	Electronic beverage center	Electronic beverage center	Electronic beverage center	In-the-door	In-the-door	Can storage rack	In-the-door	In-the-door	
Interior light system	GE Reveal™	GE Reveal	GE Reveal	Tri-level	Tri-level	Tri-level	Tri-level	Tri-level	
Quiet design	Premium	Premium	Premium	Premium	Premium	Premium	Premium	Premium	
AutoEnergy saver	●	●	●	●	●	●	●	●	
NeverClean™ condenser	●	●	●	●	●	●	●	●	
ENERGY STAR®	●	●	●	●	●	●	●	●	
Freezer features									
FrostGuard™ technology	●	●	●	●	●	●	●	●	
Integrated Ice™ system	●	●	●	●	●	●	●	●	
Wire slide-out baskets	4 (3 full-ext.)	4 (3 full-ext.)	4 (3 full-ext.)	4 (3 full-ext.)	4 (3 full-ext.)	4 (3 full-ext.)	4 (3 full-ext.)	4 (3 full-ext.)	
Wire cabinet shelves	2	2	2	2	2	2	2	2	
Wire tilt-out door bin(s)	3 (2 adj.)	3 (2 adj.)	3 (2 adj.)	3 (2 adj.)	3 (2 adj.)	3 (2 adj.)	3 (2 adj.)	3 (2 adj.)	
Door shelves	1	1	1	1	1	1	1	1	
Interior light	GE Reveal	GE Reveal	GE Reveal	Dual	Dual	Dual	Dual	Dual	
Exterior									
Color(s) available*	SS	SS	WW, BB	SS	SS	SS	SS	WW, CC, BB	
Door handle(s)	Sculptured stainless steel	Sculptured stainless steel	Color-matched sculptured	Sculptured stainless steel	Sculptured stainless steel	Sculptured stainless steel	Sculptured stainless steel	Color-matched sculptured	
Exterior design	Full-wrap contoured doors	Contoured doors	High-gloss contoured doors	Contoured doors	Contoured doors	Contoured doors	Contoured doors	High-gloss contoured doors	
Textured steel door and case		Case only (black)	Case only	Case only (black)	Case only (black)	Case only (black)	Case only (black)	Case only	
Stainless steel side panel accessory (optional)		●			●	●	●		
Adjustable rollers	Front	Front	Front	Front	Front	Front	Front	Front	
Weights & Dimensions									
Height to top of hinge (in.) A	70-3/4††	69-1/4	69-1/4	69-1/4	69-1/4	69-1/4	69-1/4	69-1/4	
Height to top of case (in.) B	68-3/4	68-3/4	68-3/4	68-3/4	68-3/4	68-3/4	68-3/4	68-3/4	
Case depth without door(in.) C †	28-1/2	28	28	28	28	28	28	28	
Case depth less door handle (in.) D†	32-3/4	32-1/4	32-1/4	33-9/16	32-1/4	32-1/4	32-1/4	32-1/4	
Case depth with door handle (in.) E†	35-3/8	34-7/8	34-11/16	36	34-7/8	34-7/8	34-7/8	34-11/16	
Depth w/fresh food door open 90° (in.) F †	50-9/16	50	50-1/16	50-1/16	50-1/16	50-1/16	50-1/16	50-1/16	
Width (in.) G	36**	35-3/4	35-3/4	35-3/4	35-3/4	35-3/4	35-3/4 / 32-3/4	34-11/16 / 32-3/4	
Width w/door open 90° w/door handle (in.) H	42-3/8	42-3/8	42	45-1/2	42-3/8	42-3/8	42-3/8 / 40-3/4	42 / 40-1/2	
	Each side (in.)	1/8	1/8	1/8	1/8	1/8	1/8	1/8	
	Top (in.)	1	1	1	1	1	1	1	
Air clearances	Back (in.)	1	1	1	1	1	1	1	
Approximate shipping wt. (lbs.)	390	360	360	350	360	360	360 / 314	360 / 314	
Power/Rating	120V, 60Hz, 15Amps								

*Color(s) available: SS = Stainless steel, WW = White, WS = White with stainless-look handles, CC = Bisque, BB = Black.

**Width excluding caps is 35-7/8".

†Water hook-up fits in back air clearance when calculating installation depth.

††When cap is removed: 69-1/4".

If installed against a wall, allow clearance of 14-3/16" on 25 cu. ft., 26 cu. ft. and 27 cu. ft. models; 13" on 29 cu. ft. models on freezer side to remove ice bin. To remove fresh food pans, remove door bins. Clearances required to remove fresh food full-size pan without disassembling: 18-15/16" on 25 cu. ft., 26 cu. ft. and 27 cu. ft.; 16-1/4" on 29 cu. ft. Allow additional space for any necessary leveling adjustments.

ALL MODELS AVAILABLE IN U.S. AND CANADA.

Energy information available at www.ge.com

	PSW26MST	PSS26MST PSS23MST	PSS26MGT PSS23MGT
	●	●	●
	25.6	25.6 / 23.1	25.6 / 23.1
	16.02	16.02 / 15.86	16.02 / 15.86
	9.59	9.59 / 7.26	9.59 / 7.26
	22.4	22.4 / 20.1	22.4 / 20.1
	●	●	●
	●	●	●
	●	●	●
	●	●	●
	●	●	●
	Plus	Plus	Plus
	Crushed ice, cubes, water	Crushed ice, cubes, water	Crushed ice, cubes, water
	●	●	●
	●	●	●
	●	●	●
	●	●	●
	●	●	●
	3 glass	3 glass	3 glass
	3	3	3
	2	2	2
	●	●	●
	●	●	●
	2	2	2
	●	●	●
	Adj. temp.	Adj. temp.	Adj. temp.
	Adj. humidity	Adj. humidity	Adj. humidity
	ExpressChill™ with 3 settings 4 (3 adj.)	ExpressChill with 3 settings 4 (3 adj.)	ExpressChill with 3 settings 4 (3 adj.)
	●	●	●
	In-the-door	In-the-door	In-the-door
	Dual-level	Dual-level	Dual-level
	Premium	Premium	Premium
	●	●	●
	●	●	●
	●	●	●
	3 (2 full-ext.)	3 (2 full-ext.)	3 (2 full-ext.)
	2	2	2
	3 (2 adj.)	3 (2 adj.)	3 (2 adj.)
	1	1	1
	Dual	Dual	Dual
	SS	SS	WW, CC, BB
	Sculptured stainless steel	Sculptured stainless steel	Color-matched sculptured
	Full-wrap contoured doors	Contoured doors	Contoured doors
		Case only (black)	●
	●	●	●
	Front	Front	Front
	70-3/4††	69-1/4	69-1/4
	68-3/4	68-3/4	68-3/4
	28-1/2	28	28
	32-3/4	32-1/4	32-1/4
	35-3/8	34-7/8	34-11/16
	50-9/16	50-1/16	50-1/16
	36**	35-3/4 / 32-3/4	35-3/4 / 32-3/4
	42-3/8	42-3/8 / 40-3/4	42 / 40-1/2
	1/8	1/8	1/8
	1	1	1
	1	1	1
	390	360 / 314	360 / 314
	120V, 60Hz, 15Amps		

Side-by-side refrigerators

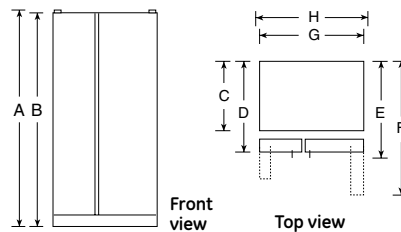

Note: Stainless steel side panel accessory (PS26SPLSS) attaches to the side of all GE Profile and GE 23, 25, 26 and 27 cu. ft. refrigerators*
 *Side panel has 1" overhang on back for model GSH25JST



GE® side-by-side refrigerators

	GE "L" Series			GE "K" Series	GE "Q" Series		GE "J" Series			
	GSW25LST	GSS25LST GSS23LST	GSS25LGT GSS23LGT	GSS25KST GSS25KGT	GSS25QST GSS23QST	GSS25QGT GSS23QGT	GSH25JST GSH22JST	GSL25JFT GSL22JFT	GSH25JFT GSH22JFT	GSS25JET GSS22JET
Stainless steel model	●	●		● / -	●		●			
Capacity										
Total (cu. ft.)	25.6	25.6 / 22.6	25.6 / 22.6	25.4	25.4 / 23.1	25.4 / 23.1	25.0 / 22.0	25.0 / 22.0	25.0 / 22.0	25.0 / 22.0
Fresh food (cu. ft.)	16.02	16.02 / 16.0	16.02 / 16.0	15.91	15.9	15.9	15.48 / 14.84	15.48 / 14.84	15.40 / 14.84	15.40 / 14.84
Freezer (cu. ft.)	9.6	9.6 / 6.6	9.6 / 6.6	9.48	9.49 / 7.26	9.49 / 7.26	9.56 / 7.14	9.56 / 7.14	9.56 / 7.14	9.56 / 7.14
Shelf area (sq. ft.)	23.8	23.8	23.8	22.6	22.9 / 20.2	22.9 / 20.2	22.3 / 20.3	22.3 / 20.3	22.3 / 20.3	22.3 / 20.3
Fresh food features										
SmartWater™ filtration system	Plus	Plus	Plus	Plus	Plus	Plus	●	●	●	
LightTouch! dispenser features	Crushed ice, cubes, water	Crushed ice, cubes, water	Crushed ice, cubes, water	Crushed ice, cubes, water	Crushed ice, cubes, water	Crushed ice, cubes, water	Crushed ice, cubes, water	Crushed ice, cubes, water	Crushed ice, cubes, water	Crushed ice, cubes, water
Light and child lock	●	●	●	●	●	●	●	●	●	●
Door alarm	●	●	●	●	●	●				
Quick Ice™ feature	●	●	●	●	●	●				
Water filter indicator light	●	●	●	●	●	●				
Actual temperature display	●	●	●	●	●	●				
External controls	●	●	●	●	●	●	●	●	●	●
TurboCool™ setting	●	●	●	●	●	●				
Cabinet shelves	3 glass	3 glass	3 glass	3 glass	3 glass	3 glass	3 glass	3 glass	3 glass	3 glass
Adjustable	3	3	3	3	3	3	3	3	3	3
Slide-out, spillproof	2	2	2	3	3	3	3	3	3	3
QuickSpace™ shelf	●	●	●	●	●	●				
Integrated shelf support system	●	●	●	●	●	●				
Snuggler™ clip				1	2	2				
Freshness Center™	●	●	●	●						
Deli drawer	1 adj. temp.	1 adj. temp.	1 adj. temp.	1 adj. humidity						
Vegetable/fruit crisper	1 adj. humidity	1 adj. humidity	1 adj. humidity	1 adj. humidity						
Sealed pan	ExpressChill™	ExpressChill	ExpressChill	1 adj. humidity						
2-stack drawer system					●		●	●	●	●
Deli drawer					1 adj. temp.	1 adj. temp.	1 adj. temp.	1 adj. temp.	1 adj. temp.	1 adj. temp.
Vegetable/fruit crisper					1 adj. humidity	1 adj. humidity	1 adj. humidity	1 adj. humidity	1 adj. humidity	1 adj. humidity
Snack pan					●	●	●	●	●	●
ClearLook™ door bins	4 (3 adj. with gallon storage)	4 (3 adj. with gallon storage)	4 (3 adj. with gallon storage)	4 (2 adj. with gallon storage)						
Door bins					4 (2 adj. with gallon storage)	4 (2 adj. with gallon storage)	4 (2 adj. with gallon storage)	4 (2 adj. with gallon storage)	4 (2 adj. with gallon storage)	4 (2 adj. with gallon storage)
Dairy compartment	●	●	●	●	●	●	●	●	●	●
Can rack				In-the-door	In-the-door	In-the-door				
J beverage rack	●	●	●							
Interior light system	Dual-level	Dual-level	Dual-level	Dual-level	Dual-level	Dual-level	Dual-level	Dual-level	Dual-level	Single-level
Quiet design	Deluxe	Deluxe	Deluxe	Deluxe	Deluxe	Deluxe	Deluxe	Deluxe	Deluxe	Deluxe
AutoEnergy saver	●	●	●	●	●	●	●	●	●	●
NeverClean™ condenser	●	●	●	●	●	●	●	●	●	●
ENERGY STAR®	●	●	●	●	●	●	●	●	●	●
Freezer features										
Factory-installed icemaker and bin					●	●	●	●	●	●
Integrated Ice™ system	●	●	●	●	●	●	●	●	●	●
FrostGuard™ technology	●	●	●	●	●	●	●	●	●	●
Wire cabinet shelves	2	2	2	4 (3 adj.)	4 (3 adj.)	4 (3 adj.)	4 (3 adj.)	4 (3 adj.)	4 (3 adj.)	4 (3 adj.)
Storage basket(s)	3 (1 slide-out)	3 (1 slide-out)	3 (1 slide-out)	1 slide-out	1 slide-out	1 clear bin	1 clear bin	1 clear bin	1 clear bin	1 clear bin
Door shelves	3 (2 tilt-out)	3 (2 tilt-out)	3 (2 tilt-out)	5	5	5	5	5	5	5
Interior light	●	●	●	●	●	●	●	●	●	●
Appearance										
Color(s) available*	SS	SS	WW, BB	SS/WW, BB	SS	WW, CC, BB	SS	CleanSteel™	WW, CC, BB	WW, CC, BB
Deluxe door handle(s)*	Stainless steel tubular	Stainless steel tubular	CM CleanTouch	Stainless steel tubular CM CleanTouch	Stainless steel tubular	CM CleanTouch	Stainless steel	CleanTouch	CM CleanTouch	CM CleanTouch
Exterior design	Stainless sides contoured doors	Contoured doors	Contoured doors	Rounded doors	Contoured doors	Rounded doors	Rounded doors	Rounded doors	Rounded doors	Rounded doors
Textured steel door and case		Case only (black)	●	Case only (black)	Case only (black)	●	Case only (black)	Case only (black)	●	●
Stain, steel side panel accessory (opt.)		●		● / -	●		● / -			
Adjustable rollers	Front	Front	Front	Front	Front	Front	Front	Front	Front	Front
Weights & Dimensions										
Height to top of hinge (in.) A	69-1/4	69-1/4	69-1/4	69-1/4	69-1/4	69-1/4	69-3/4 / 67-1/2	69-3/4 / 67-1/2	69-3/4 / 67-1/2	69-3/4 / 67-1/2
Height to top of case (in.) B	68-3/4	68-3/4	68-3/4	68-3/4	68-3/4	68-3/4	68-3/4 / 66-1/2	68-3/4 / 66-1/2	68-3/4 / 66-1/2	68-3/4 / 66-1/2
Case depth without door (in.) C†	28	28	28	28	28	28	28	28	28	28
Case depth less door handle (in.) D†	32-1/4	32-1/4 / 31-1/4	32-1/4 / 31-1/4	31-1/4	31-1/4	31-1/4	31-1/4	31-1/4	31-1/4	31-1/4
Case depth with door handle (in.) E†	34-7/8	34-7/8 / 33-9/16	34-11/16	33-9/16	33-9/16	33-9/16	33-9/16	33-9/16	33-9/16	33-9/16
Depth w/fresh food door open 90° (in.) F†	50-1/16	50-1/16	50-1/16	50-1/16	50-1/16	50-1/16	49-3/8	49-3/8	49-3/8	49-3/8
Width (in.) G	35-3/4	35-3/4 / 32-3/4	35-3/4 / 32-3/4	35-3/4	35-3/4 / 32-3/4	35-3/4 / 32-3/4	35-3/4 / 33-1/2	35-3/4 / 33-1/2	35-3/4 / 33-1/2	35-3/4 / 33-1/2
Width w/door open 90° with door handle (in.) H	42-3/8	42-3/8 34-1/4	42 34-1/4	41-3/16	36-1/4 34-3/4	36-1/4 34-3/4	38-3/16 35-15/16	38-3/16 35-15/16	38-3/16 35-15/16	38-3/16 35-15/16
Each side (in.)	1/8	1/8	1/8	1/8	1/8	1/8	1/8	1/8	1/8	1/8
Air clearances	Top (in.)	1	1	1	1	1	1	1	1	1
Back (in.)	1	1	1	1	1/8	1/8	1	1	1	1
Approx. shipping wt. (lbs.)				320	310 / 296	310 / 296	344 / 323	344 / 323	344 / 323	344 / 323
Power/Ratings	120V, 60Hz, 15Amps									

*Color(s) available: SS = Stainless steel, WW = White, CC = Bisque, BB = Black, CleanSteel = Stainless appearance, CM = Color-Matched.

†Water hook-up fits in back air clearance when calculating installation depth. If installed against a wall, allow clearance of 10-3/4" on 20 cu. ft. and 22 cu. ft. models; 14-3/16" on 25 cu. ft. models on freezer side to remove bin. Clearances required to remove fresh food full-size pan without disassembling: 13-1/2" on 20 cu. ft., 15" on 22 cu. ft., and 18-15/16" on 25 cu. ft. Allow additional space for any necessary leveling adjustments.

ALL MODELS AVAILABLE IN U.S. AND CANADA.

Side-by-side refrigerators

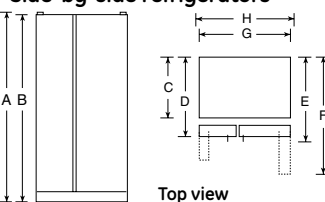

Note: Stainless steel side panel accessory (PS26SPLSS) attaches to the side of all GE Profile and GE 23, 25, 26 and 27 cu. ft. refrigerators.*
*Side panel has 1" overhang on back for model GSH25JST.



Listed by Underwriters Laboratories

	GE "I" Series		GE "D" Series
	GSS20IET	GSS22IBT GSS20IBT	GSS20DBT
Capacity			
Total (cu. ft.)	20.0	21.9 / 19.9	19.9
Fresh food (cu. ft.)	12.87	14.87 / 12.87	12.87
Freezer (cu. ft.)	7.14	7.04	7.04
Shelf area (sq. ft.)	17.3	21.1 / 18.0	18.1
Fresh food features			
SmartWater filtration system			
LightTouch dispenser features	Crushed ice, cubes, water		
Child lock	●		
Light	●		
External controls	●		
Upfront electronic dial temperature controls	●	●	●
Cabinet shelves	3 glass	3 glass	3 wire
Adjustable	3	3	3
Spillproof			
Deli drawer	1 sealed	1 sealed	1 sealed opaque
Vegetable/fruit crisper	1 sealed	1 sealed	1 sealed opaque
	4 (1 with gallon storage)	4 (1 with gallon storage)	4 (1 with gallon storage)
Door bins			
Dairy compartment	●	●	●
Interior light system	Single-level	Single-level	Single-level
Quiet design	Deluxe	Deluxe	Deluxe
AutoEnergy saver	●	●	●
NeverClean condenser	●	●	●
Freezer features			
Factory-installed icemaker and bin	●	Opt. (IM6)	Opt. (IM6)
FrostGuard technology	●	●	●
Wire cabinet shelves	3 (2 adj.)	5 (4 adj.) 4 (3 adj.)	4 (3 adj.)
Storage basket(s)	1 bin	1 bin	1 bin
Door shelves	5	5	6
Interior light	●	●	●
Appearance			
Color(s) available*	WW, CC, BB	WW, CC	WW, CC
Door handle(s)*	CM CleanTouch	CM CleanTouch	CM CleanTouch
Textured steel door and case	●	●	●
Adjustable rollers	Front	Front	Front
Weights & Dimensions			
Height to top of hinge (in.) A	67-1/2	67-1/2	67-1/2
Height to top of case (in.) B	66-1/2	66-1/2	66-1/2
Case depth without door (in.) C†	28	28	28
Case depth less door handle (in.) D†	31-1/4	31-1/4	31-1/4
Case depth with door handle (in.) E†	33-9/16	33-9/16	33-9/16
Depth with fresh food door open 90° (in.) F†	47-3/8	49-3/8 / 47-3/8	47-3/8
Width (in.) G	31-1/2	33-1/2 / 31-1/2	31-1/2
Width w/door open 90° with door handle (in.) H	33-15/16	35-15/16 33-15/16	33-15/16
Each side (in.)	1/8	1/8	1/8
Top (in.)	1	1	1
Back (in.)	1	1	1
Air clearances			
Approx. shipping wt. (lbs.)	306	321/ 306	306
Power/Ratings	120V, 60 Hz, 15Amps		

*Color(s) available: WW = White, CC = Bisque, BB = Black, CleanSteel = Stainless appearance, CM = Color-Matched.
†Water hook-up fits in back air clearance when calculating installation depth.

If installed against a wall, allow clearance of 10-3/4" on 20 cu. ft. and 22 cu. ft. models; 14-3/16" on 25 cu. ft. models on freezer side to remove bin.
Clearances required to remove fresh food full-size pan without disassembling: 13-1/2" on 20 cu. ft.; 15" on 22 cu. ft.; and 18-15/16" on 25 cu. ft.
Allow additional space for any necessary leveling adjustments.

ALL MODELS AVAILABLE IN U.S. AND CANADA.

Side-by-side refrigerators

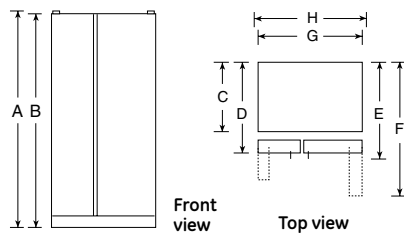

Listed by Underwriters Laboratories



A Century of Quality and Innovation

For more than a century, GE has been committed to producing innovative products that change the way people live. The result of thorough research and rigorous testing, GE appliances are designed for years of dependable performance. Today, the GE tradition of quality and innovation continues.