

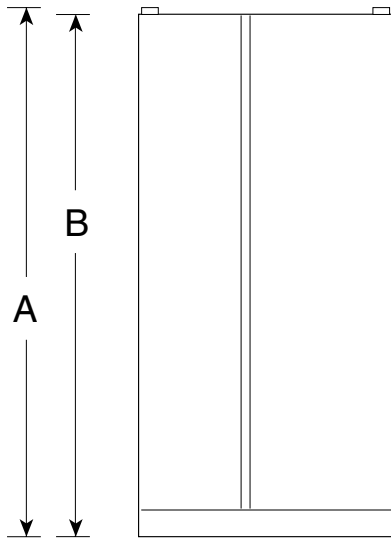

# Profile Performance Series™

## TFX28PPDWW - GE Profile Performance™ 28.4 Cu. Ft. Side-by-Side Refrigerator with Dispenser

Front View



Top View

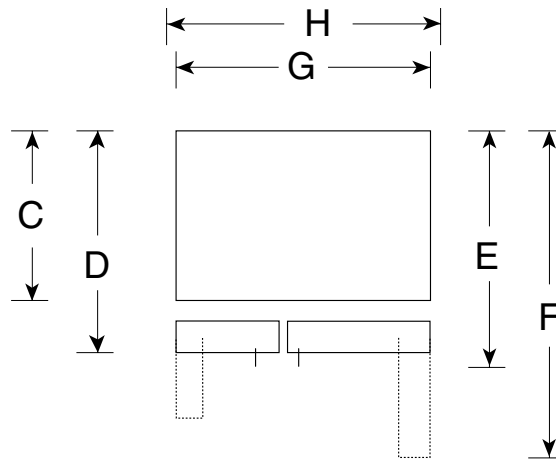

**Note:** If the doors cannot be fully opened because of an obstruction or a wall on either side, a door stop should be provided to prevent door or wall damage. If the doors cannot be opened at least 90 degrees, access to the drawers is limited.

<b>Overall Dimensions</b>	Height with hinge (in.) <b>A</b>	<b>69-3/4</b>
	Height without hinge (in.) <b>B</b>	<b>68-3/4</b>
	Depth without Doors (in.) <b>C</b>	<b>28</b>
	Depth with Doors (in.) <b>D</b>	<b>30-1/2</b>
	Depth plus Handle with Doors Closed (in.) <b>E</b>	<b>32-5/8</b>
	Depth with Doors open 90° (in.) <b>F</b>	<b>49-3/8</b>
	Width with Doors Closed (in.) <b>G</b>	<b>35-3/4</b>
	Width with Doors open 90° Less Door Handle(in.) <b>H</b>	<b>38</b>
<b>Air Clearances</b>	Each side (in.)	<b>1/8"</b>
	Top (in.)	<b>1</b>
	Back (in.)	<b>1/2</b>

\*If installed against a wall, allow clearance of 11-1/4" on freezer side to remove ice bin.

To remove fresh food pans, remove door bins.

15-3/4" Clearance required to remove fresh food full-size pan without disassembling.

For Built-In appearance allow height space of 69-3/4" on 28 cu. ft. refrigerators. Plus allow additional space for any necessary leveling adjustments.

For answers to your Monogram®, GE Profile Performance Series™, GE Profile™ or GE appliance questions, call GE Answer Center® service, 800.626.2000.



Total volume and shelf area are calculated by the Association of Home Appliance Manufacturers' standards.



Listed by Underwriters Laboratories



EnergySmart



*Profile Performance Series™*

## TFX28PPDWW - GE Profile Performance™ 28.4 Cu. Ft. Side-by-Side Refrigerator with Dispenser

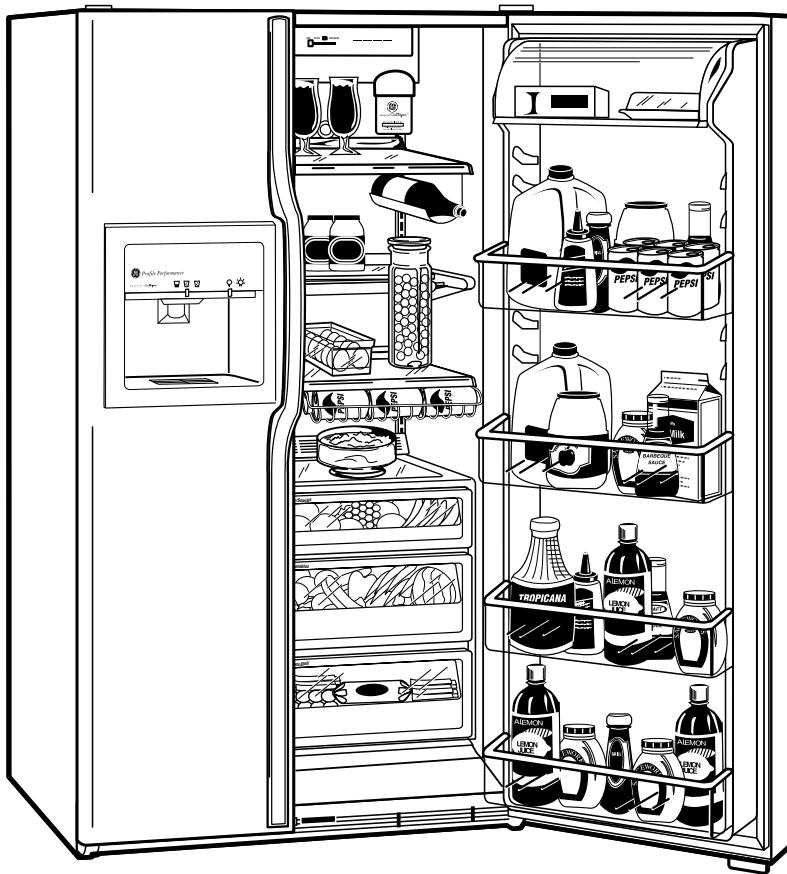

### Features and Benefits

- 28.4 cu ft Capacity (Fresh Food 17.23 cu ft / Freezer 11.18 cu ft)
- Exclusive Water by Culligan™ Provides Cleaner, Better Tasting Water and Ice Through the LightTouch! Dispenser (Chilled Water, Cubes and Crushed Ice)
- Freshness Center™ (1 Adjustable Humidity Crisper, 1 Convertible Meat Keeper with Cold Control and 1 Adjustable Humidity Snack Pan) with Spill-Proof Cover
- 3 Adjustable Glass Fresh Food Cabinet Shelves (2 Slide Out, Spill Proof)
- Quick Space™ Shelf
- ShelfSaver™
- 4 ClearLook™ Modular Gallon Door Bins (2 Adjustable)
- Dairy Compartment with Glass Butter Dish
- Egg Bin
- Beverage Rack
- 3 Wire Everwhite, Freezer Compartment Shelves (2 Adjustable)
- 1 Wire Everwhite, Slide Out Freezer Basket
- 1 Clear Sliding Freezer Storage Bin
- 4 Freezer Door Shelves (2 Adjustable)
- Quiet Package II
- Color-Matched Premium Deluxe Door Handles
- Model TFX28PPDWW - White on white
- Model TFX28PPDBB - Black on black
- Model TFX28PPDAA - Almond on almond
- Model TFX28PPDCC - Bisque
- Model TFS28PPDBS - Stainless steel